

1 PLAN :: GROUND FLOOR
 A1 1/4" = 1'-0"

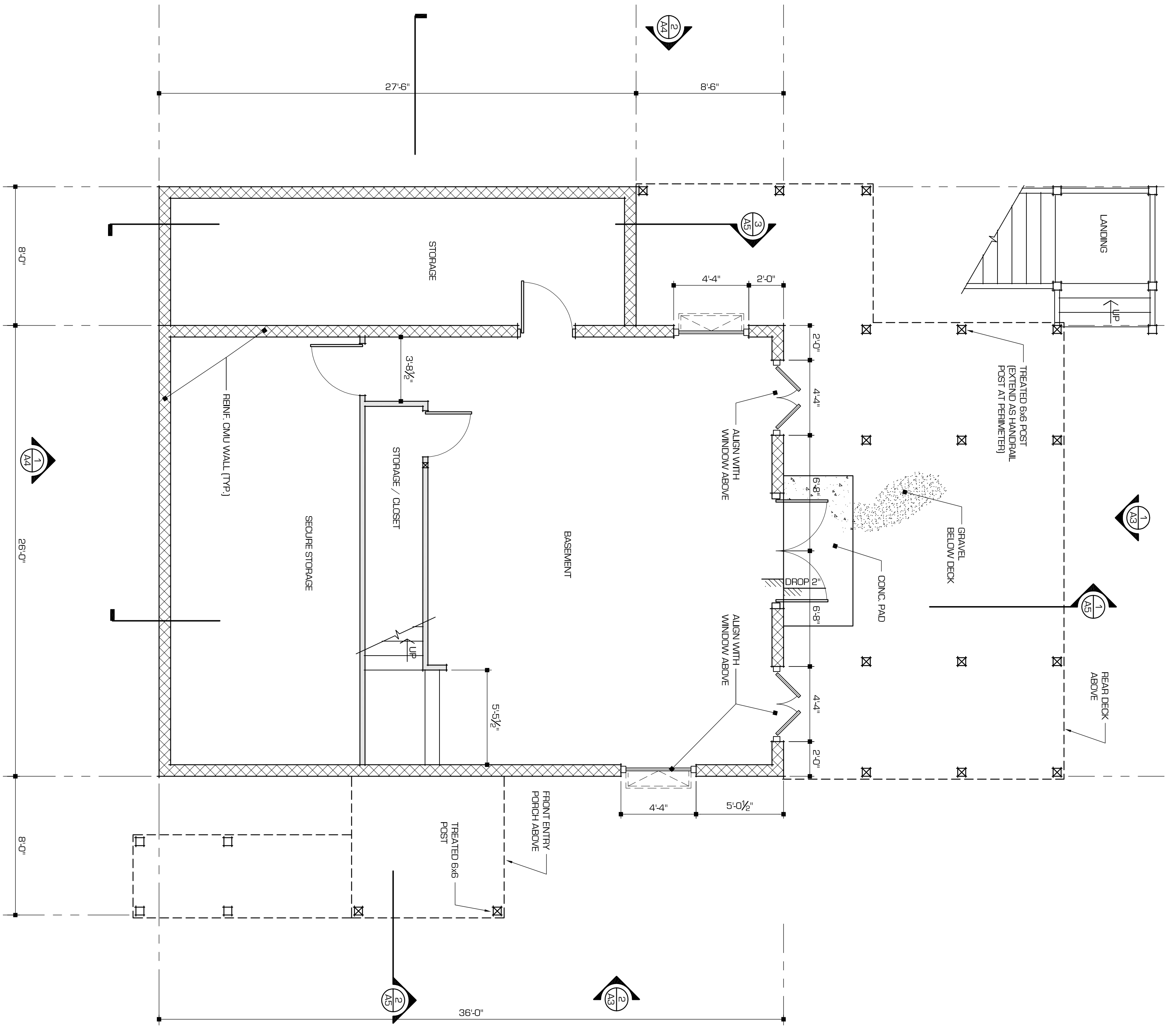

2 PLAN :: FIRST FLOOR
 A1 1/4" = 1'-0"

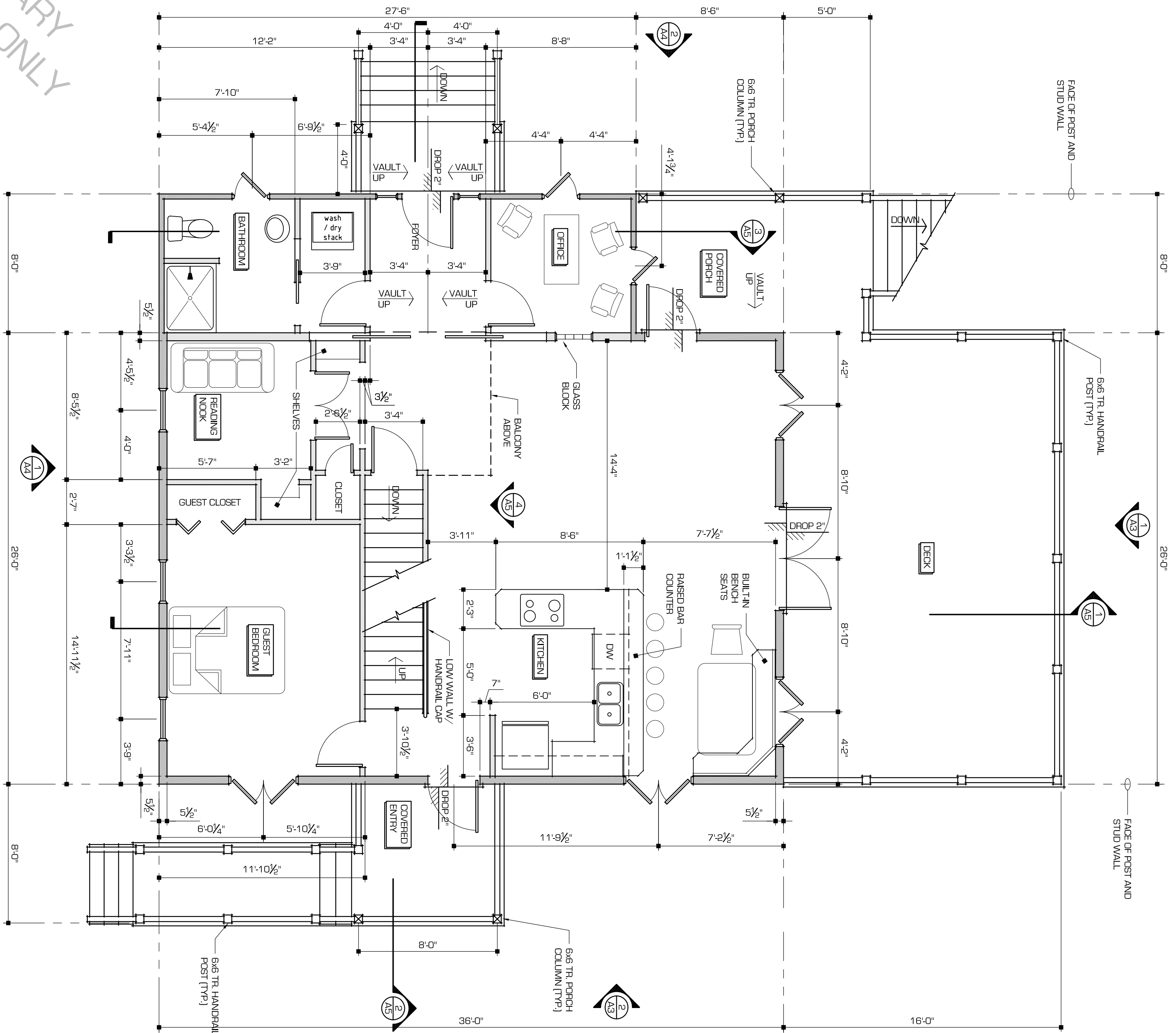

PRELIMINARY
 FOR REVIEW ONLY

1156 sq HEATED
 1342 sq FLOORFINISH

SPECIAL NOTES

1. The Contractor shall assume total responsibility for structural design, including foundations, soils engineering, concrete, steel reinforcing, framing bracing for lateral stability, and all other components. If necessary, the Contractor shall hire a Registered Structural Engineer to assist with structural designs.
2. The Contractor shall check and verify all dimensions prior to construction.
3. The Contractor shall abide by all applicable local, state, and federal codes, laws, and ordinances.
4. ECM III Design & Drafting, LLC is a general purpose drafting operation and makes no representation regarding adequacy of materials, specifications, detailing, electrical, plumbing, mechanical, or structural systems.

TAPSCOTT RIVER COTTAGE

Revision	Date
	00.00.00

ECM III
DESIGN & DRAFTING, LLC
 843.762.6993 :: 843.442.4184

BASEMENT
 & 1st FLOOR
 PLAN

A1

10.30.08